

**FOR LEASE: Creative Professional Office**

# 20:20 Complex

21st & NE Alberta Street

**88% Pre-leased!**



- Mixed use multi-tenant project with completion scheduled for December 2012
- Creative office space with exposed ceilings and concrete floors
- Each suite will be plumbed with a kitchenette, HVAC ducted for open use, CAT 6 wired, and perimeter electrical boxes installed, operable windows, lots of light
- 493-2,434 SF suites available, 2nd floor office space

## CONTACT

Ben McInnis  
503 819 3374  
ben.mcinnis@bencocre.com



# 20:20 Complex

21st Ave & NE Alberta Street

## 2nd Floor

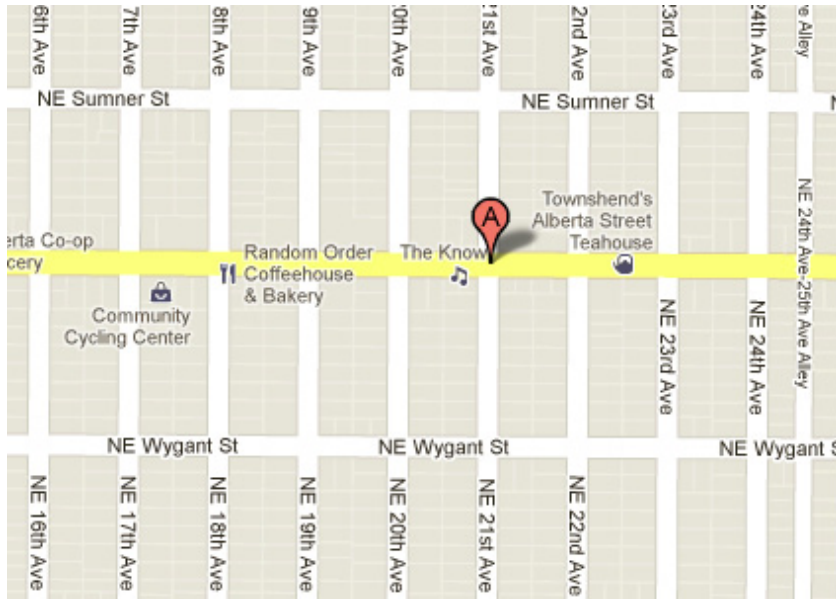
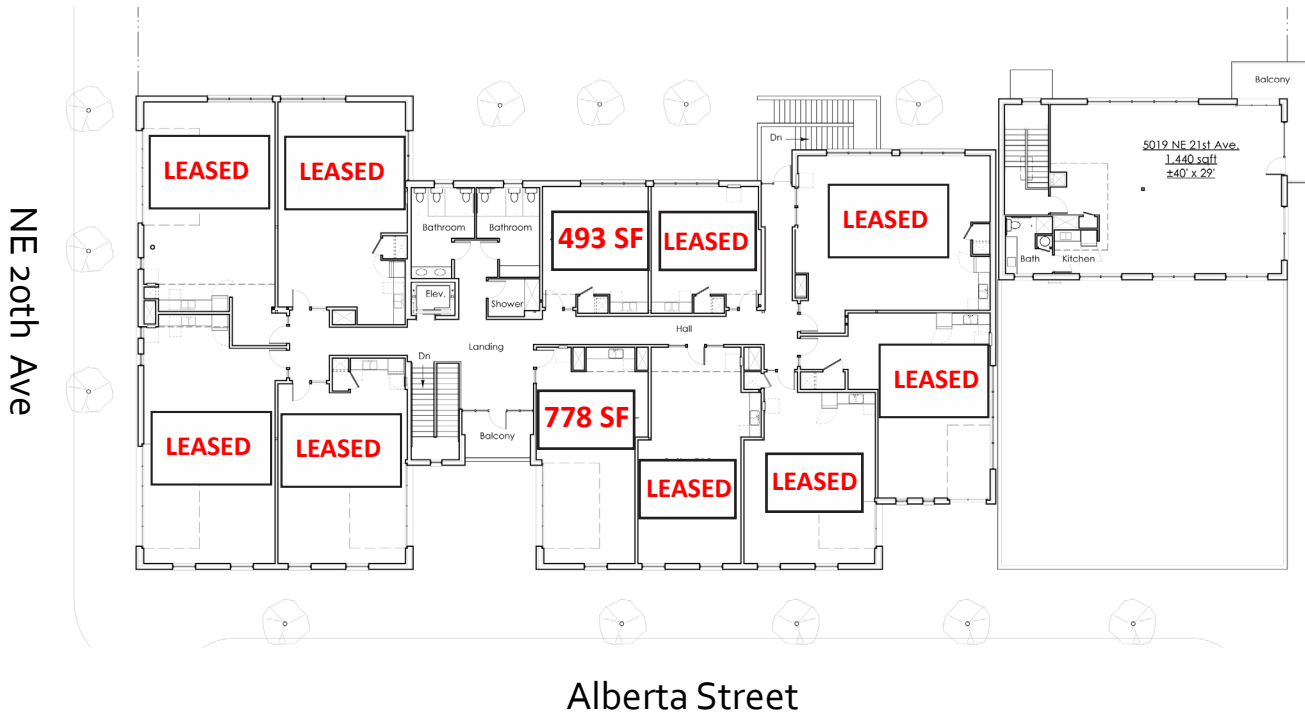

## CONTACT

Ben McInnis  
503 819 3374  
ben.mcinnis@bencocre.com



www.bencocre.com

1750 SW Harbor Way, Suite 250 Portland, OR 97201

This statement with the information it contains is given with the understanding that all negotiations relating to the purchase, renting, or leasing of the property described above shall be conducted through Benco Commercial Real Estate, LLC. The above information, while not guaranteed, has been secured from sources we believe to be reliable.